



# FLOW MEASURING WITH FLOW INDICATOR



[www.aramakco.com](http://www.aramakco.com)



## Introductions

Sight Glass (Sight Flow Indicators) are generally used in processes, where spot required to detect presence of media, or to visual inspect color, clarity, turbidity, or other critical characteristics. Sight Glass can be installed vertically or horizontally in the middle of any kind of non transparent pipeline and are very convenient & easy to observe the flow from any direction.

Global Steel & Engineering Tubular Type Sight Glass available with different length of glass from 1/2" (25mm) to 12 (300mm) long.

Global Steel & Engineering Sight Glass (Sight Flow Indicators) has been designed with outstanding quality and the feature you need to streamline your operations. Full view types Sight Glass (Sight Flow Indicators) are widely used for corrosive chemicals, acids and colored liquids.

## Applications

- Powder
- Bulk Solids
- Food Handling
- Beverages
- Dairy
- Liquids
- Clean systems

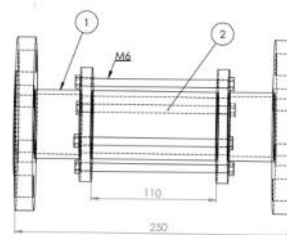
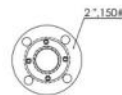

360° view



Double view



## Specification

### Fluids :

Liquids, gases and saturated steam

### Line sizes :

1/2" to 12" (DN 15 to DN 300)

### Flow Indicator materials

- Carbons Steel
- S.S 304
- S.S 316
- Titanium
- Monel
- Hast Alloy
- PVC
- PVDF
- PP

### End Connection

- Flanged connection is available on to ASME or PN
- Thread 1/4" to 2" (G or NPT)

### Maximum pressure

100 Bar @ 45 °C

### Temperature :

-10 ~200 C

### Gasket:

P.T.F.E. (Teflon )/ Silicon/NBR

### Glass:

Tempered Borosilicate Glass

### Fasteners:

Carbon Steel, Stainless Steel 304

### Total Length:

Adjustable according to client specification

### Additional Option:

- Illuminator

- Heated Jacket

### Indication Type:

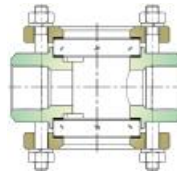

Through Type

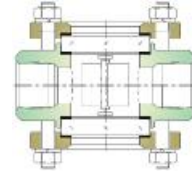

Propeller Type

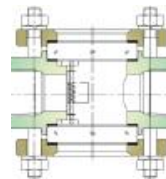

Flapper Type

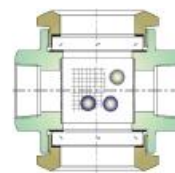

Ball Type

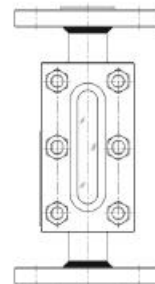

- Side Type



## Ordering Information

FI	XXX	XXXX	XX	XX	XXX	X	XX
<b>Indicator Type</b>	XXX						
Through 360 view	TC						
Propeller 360 view	PC						
Flapper 360 view	FC						
Ball 360 view	BC						
Through double view	TD						
Propeller double view	PD						
Flapper double view	FD						
Ball double view	BD						
Side	ST						
<b>Total length ( )</b>							
... mm (100 to 999 mm)		XXXX					
<b>Body Material</b>							
Carbone Steel		CS					
Stainless steel 316L		S1					
Stainless steel 304L		S3					
PVC		PV					
PP		PP					
PVDF		PD					
Monel 400		H2					
Inconel 600		H3					
Duplex		H4					
Super duplex		H5					
Titanium		H6					
Others		H7					
<b>Oring material</b>							
PTFE			P				
NBR			N				
Silicon			S				
Others			O				
<b>Process connection</b>							
1/4"				Y0			
1/2"				F10			
3/4"				F11			
1"				F12			
1 1/2"				F13			
2"				F14			
3"				F15			
4"				F16			



## Ordering Information

<b>Connection Type</b>		
NPT	1	
G	2	
ASME Flanged	3	
DIN Flanged	4	
Other	5	
<b>Additional Options</b>		
Material Certificate		N1
Nace Certificate		N2
Dimension Reprint		D1
Drawings Document		D2
illuminator		I1
Heated Jacket		H1
Helium leak testing		U1
Pressure internal (water)		U3
Radiograph process connection		W1
Weld location report		W2
Weld qualification report		W3
Wake frequency calculation		W4
Hardness report		H1



## Contact us

**Instrumentation  
manufacturer  
& designer**

Tel : 021-46069694

Aramakco.com

Info@aramakco.com

Sales@aramakco.com